

Magnetic Assemblies

CY-CN Series, NdFeB Plastics Injected, Zinc Plated

CY-CN Series with NdFeB

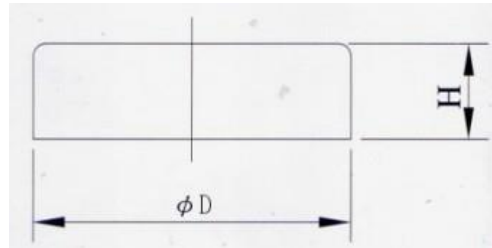

Type	Dimensions (mm)		Weight (g)	Adhesive Force (N)
	ϕD	H		
CY-CN6	6	4.5	2	5
CY-CN8	8	4.5	2	13
CY-CN10	10	4.5	3	25
CY-CN13	13	4.5	5	60
CY-CN16	16	4.5	7	95
CY-CN20	20	6	15	140
CY-CN25	25	7	22	200
CY-CN32	32	7	40	350